

①

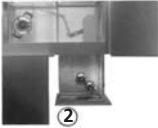

②

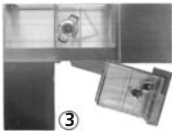

③



'MAGIC' CORNER UNIT optimises space in 1000 mm corner base units.

Door pulls out first set of trays and then swings sideways which moves the second set of trays out from blind corner



PULL-OUT BASKETS. Chrome plated wire baskets for 400–1000 mm wide base units

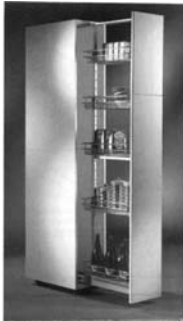

PULL-OUT LARDER. Centre-mounted, height adjustable wire baskets for 300, 500 and 600 mm wide tall units



CAROUSEL TRAYS. $\frac{1}{2}$ round chrome wire trays for 900 and 1000 mm wide corner base units



CAROUSEL TRAYS. $\frac{3}{4}$ circle chrome wire trays for 900 × 900 mm corner base unit

Wire shelving for cabinet interiors



GLASS RACK for fitting inside 500 mm wide tall or wall units



FIRST AID CABINET lockable 260 × 182 × 245 w

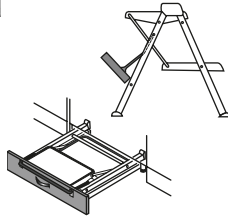

STEP STOOL for storing in plinth space 390 w × 390 d × 385 h unfolded 390 w × 95 d × 465 w folded

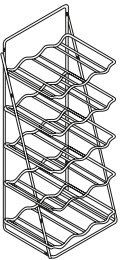

WINE RACK for 300 mm wide base unit



SLIDING TOWEL RAIL in chrome for side or top fixing under worktop - L or R hand 480 l (closed) × 102 w × 36 w

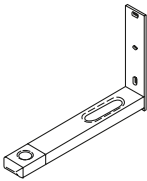

MICROWAVE WALL BRACKETS adjustable 330–460 mm

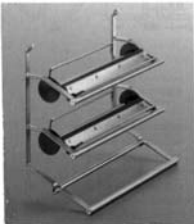

ROLL HOLDER for cling film foil and paper towels 352 w × 150 d × 305 w

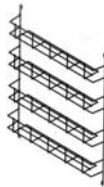

SPICE RACK for door interiors 395 w × 55 d × 500 h



CUTLERY INSERT two tier in white plastic for 500 mm wide drawer

Cabinet and wall-hung fittings